

- Notes:
- Sacking / burlap to be loosened and dropped to the bottom of the planting hole. All string, twine, etc. to be removed.
 - All wire baskets shall have the top 1/3 of the wire removed prior to planting.
 - All trees shall be single stem.

1 DECIDUOUS TREE PLANTING
Scale 1:25

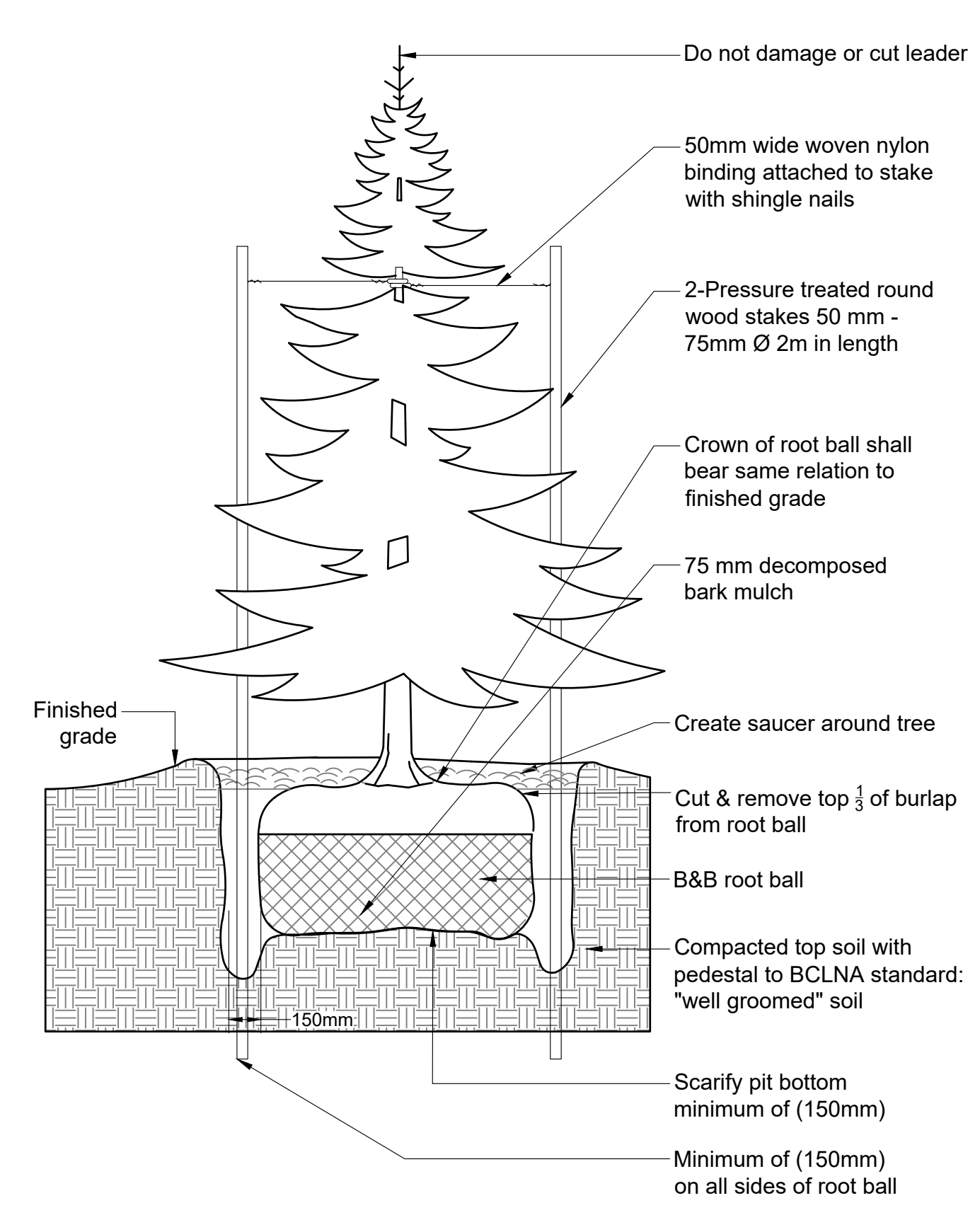

- Notes:
- Do not damage main roots or destroy root ball when installing tree stake.
 - Water thoroughly after installation.
 - Remove tree rings and stakes two years after installation.
 - Provide drainage for planting pit in impermeable soil.

2 CONIFEROUS TREE PLANTING
Scale 1:25

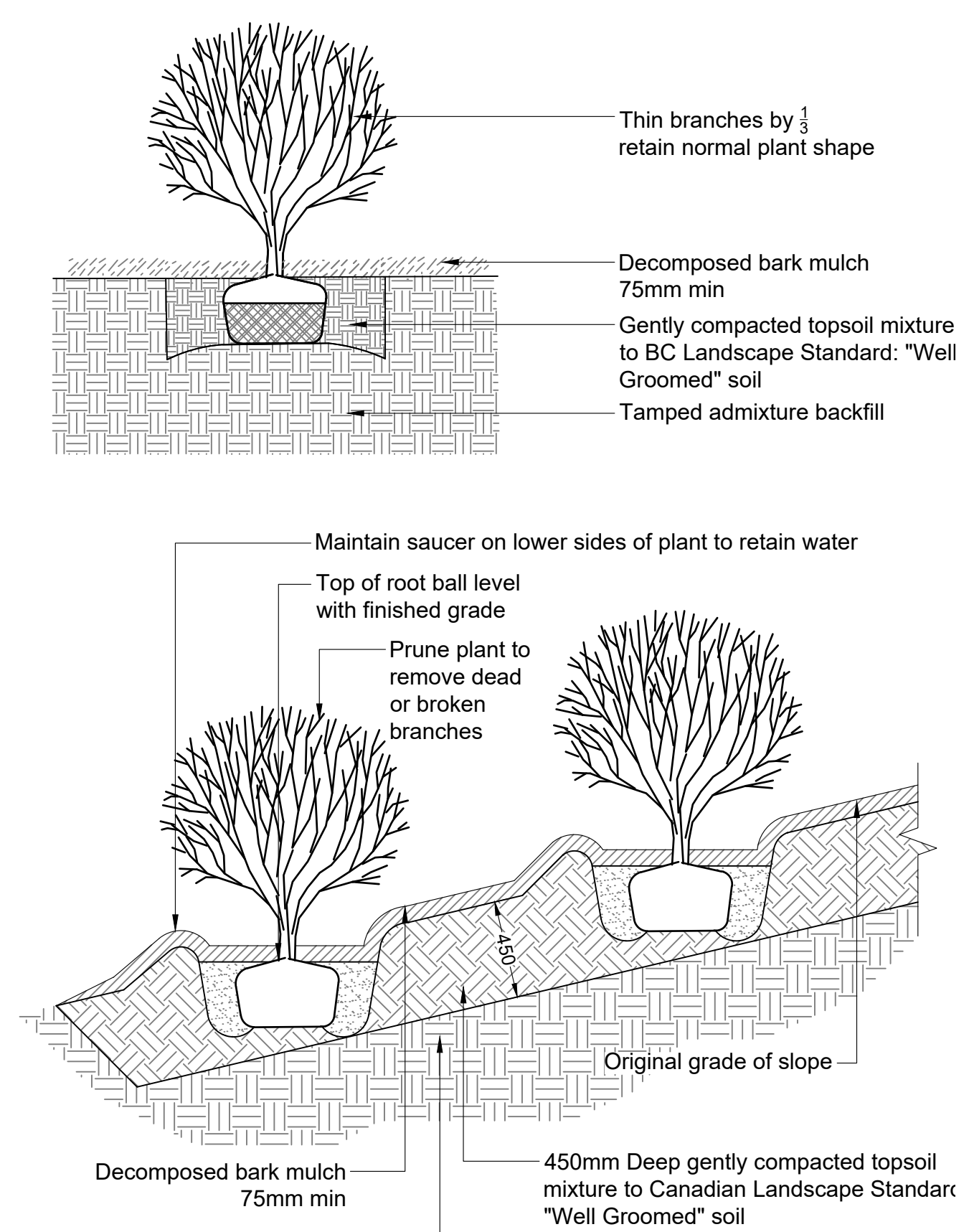

- Notes:
- Remove all string, twine, pots, tags from plant.
 - All soil, mulch and plant material to meet latest Canadian Landscape Standard.
 - O.C. spacing per planting plan.

3 SHRUB PLANTING
Scale 1:25

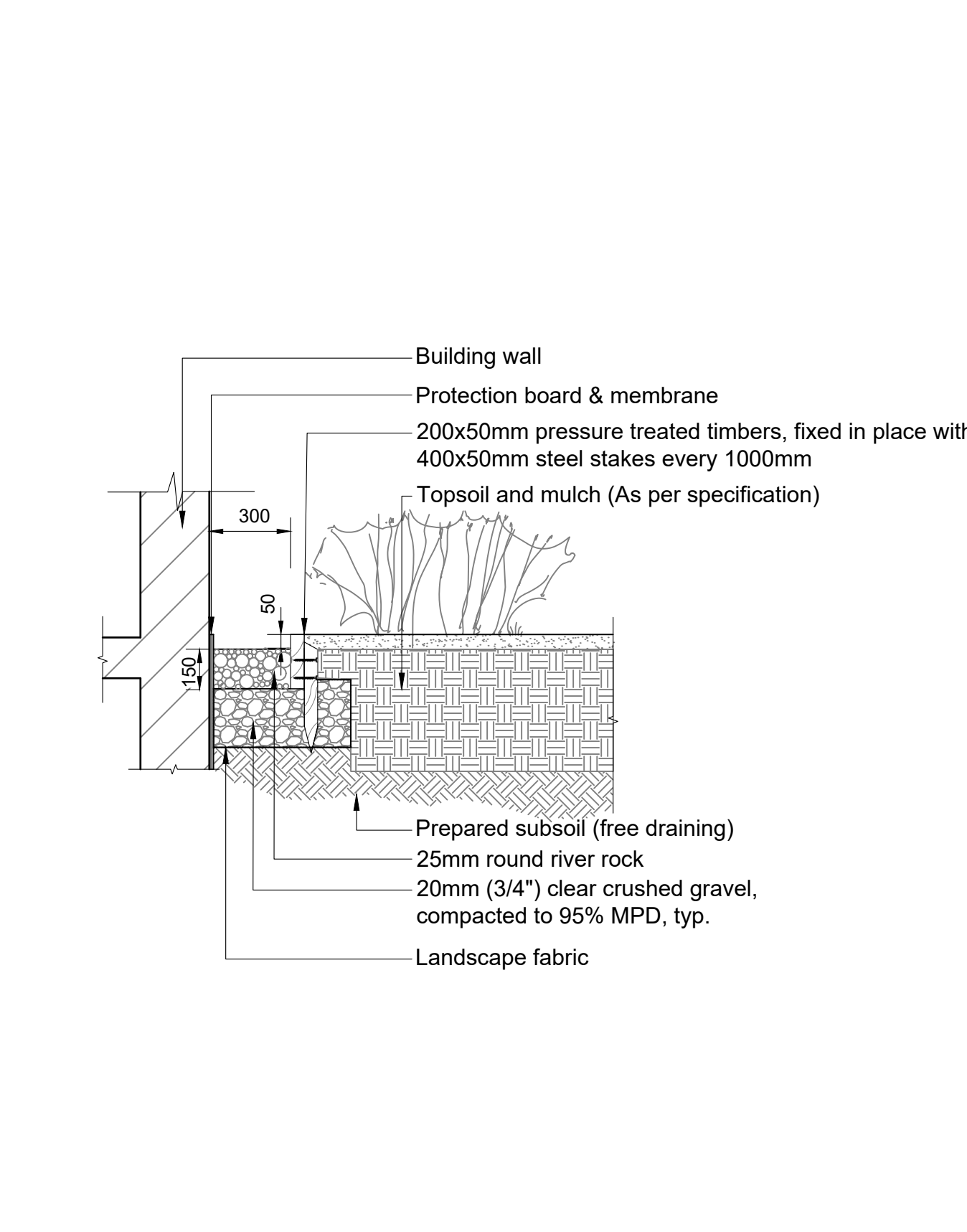

4 DRIP STRIP
Scale 1:20

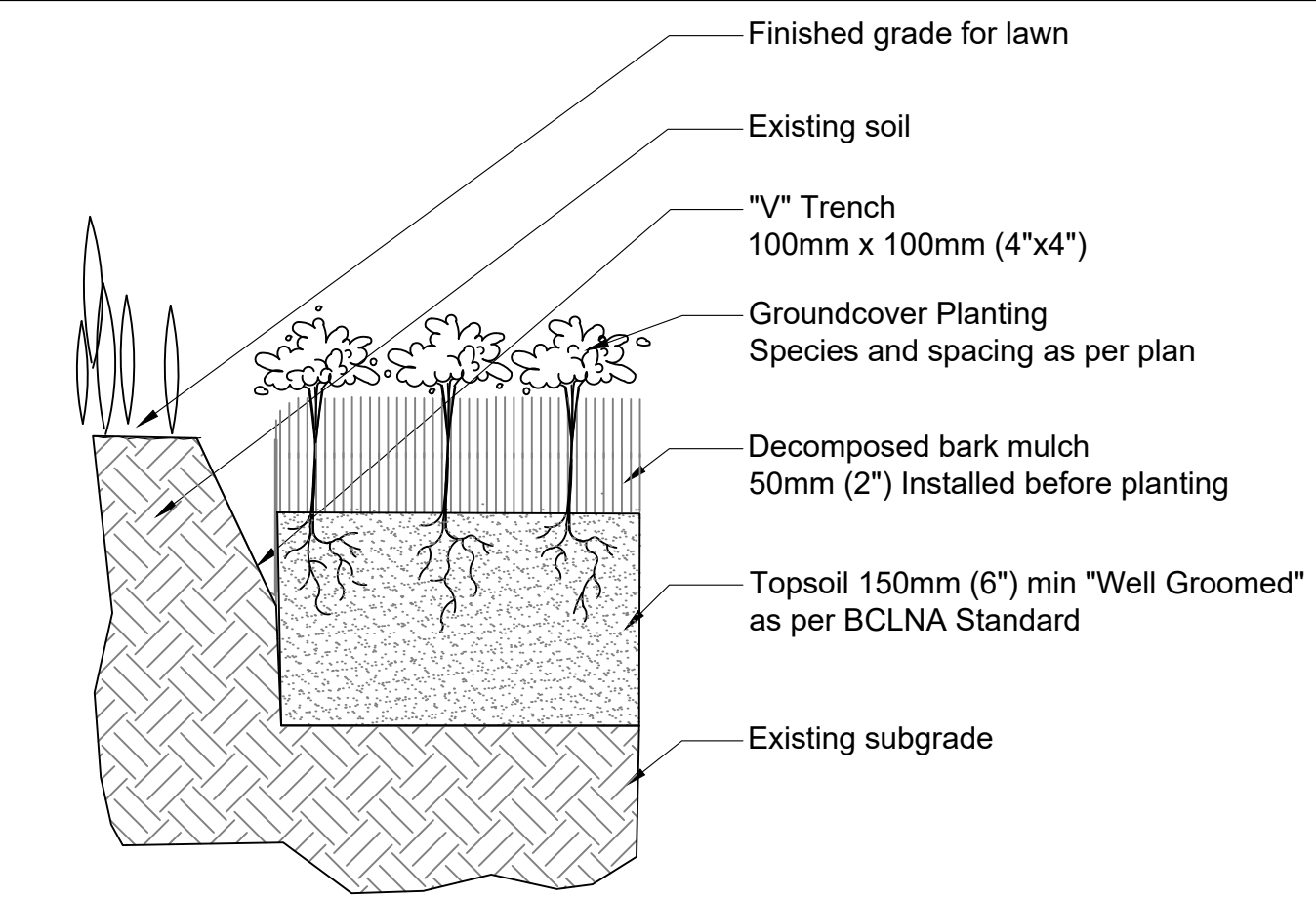

5 BED PREPARATION EDGE TRENCH
Scale 1:10

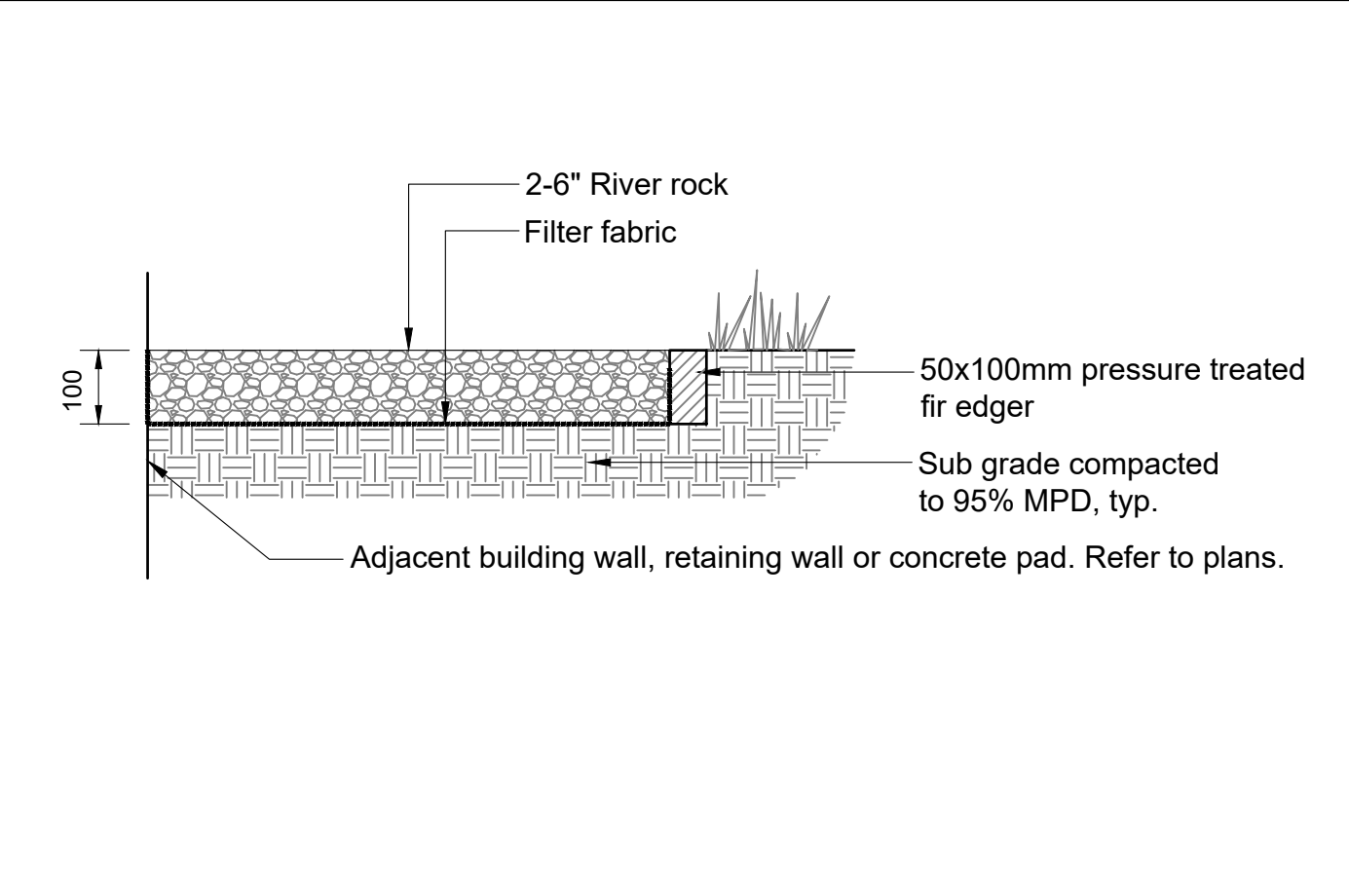

7 RIVER ROCK
Scale 1:10

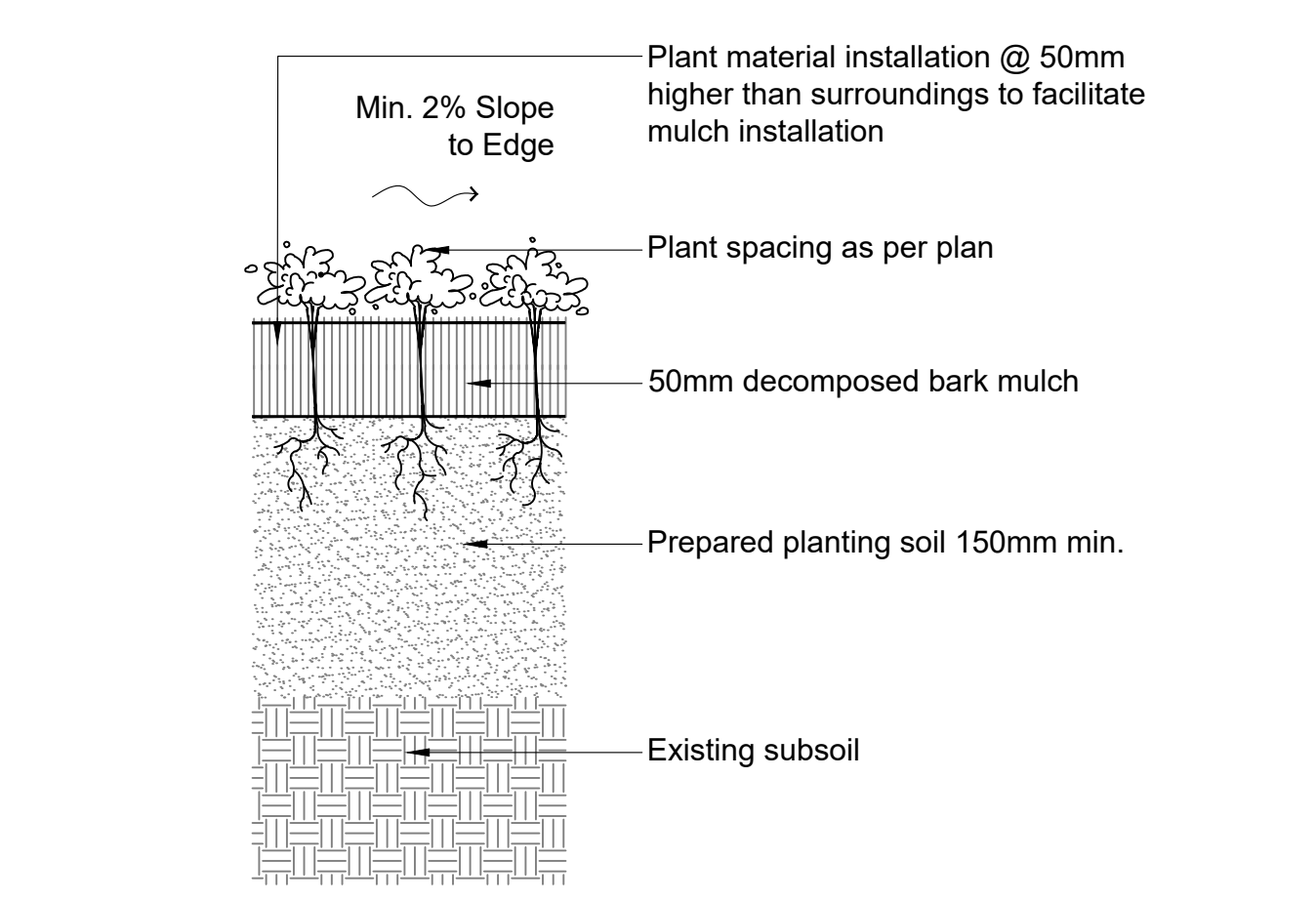

6 GROUNDCOVER PLANTING
Scale 1:10

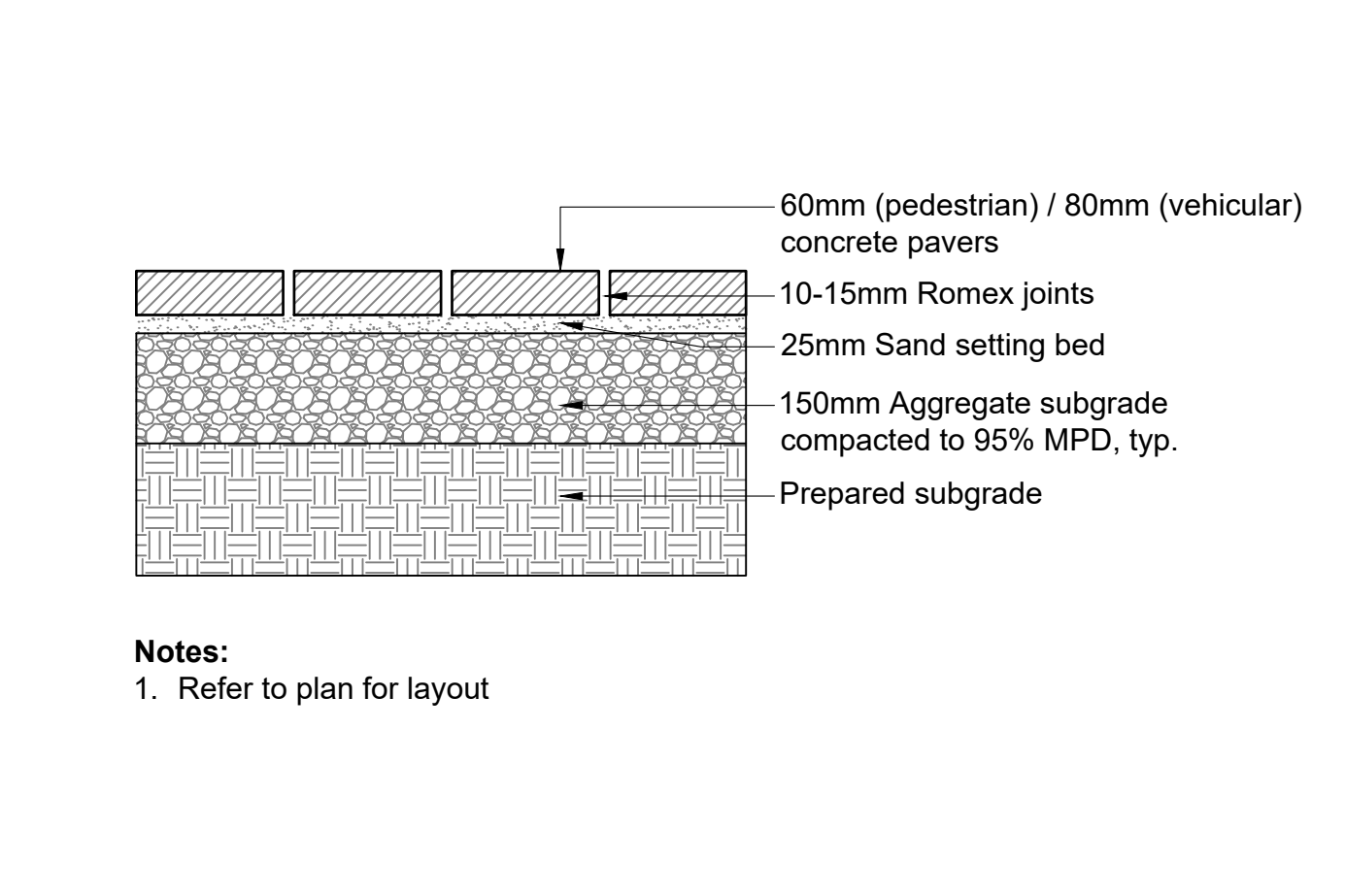

8 UNIT PAVERS
Scale 1:10



9 COBBLESTONE WALKWAY
Scale NTS

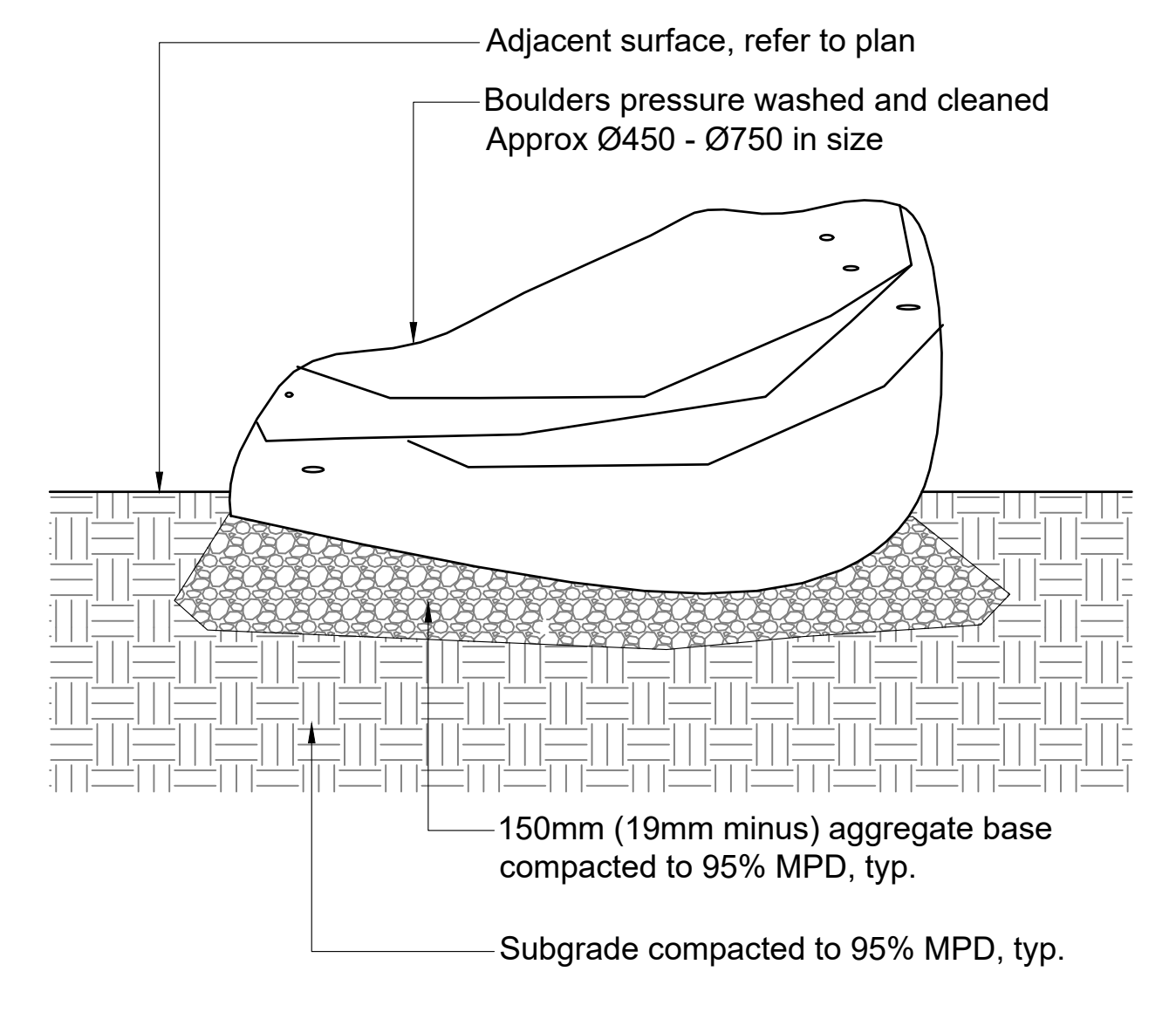

- Notes:
- Basalt boulders from Northwest Landscape Supply. No sharp edges.
 - Boulders to be buried in the ground approx. 1/3 of their height.

10 FEATURE BOULDER
Scale 1:20

Stamp:

#	By	Description	Date
TABLE OF REVISIONS			

Details

Scale:
AS SHOWN
Original Sheet Size:
24"x36" (ARCH D)

Project Name:
Horseshoe Bay Rowhouse
Development

Project Address:
6544 Royal Ave. & 6388 Douglas St.
West Vancouver, BC

Project Number:

Client / Owner: _____ Drawn: LG
Checked: AL
Approved: AL

CONTRACTOR SHALL CHECK ALL DIMENSIONS ON THE WORK AND REPORT ANY DISCREPANCY TO THE CONSULTANT BEFORE PROCEEDING. ALL DRAWINGS AND SPECIFICATIONS ARE THE EXCLUSIVE PROPERTY OF THE OWNER AND MUST BE RETURNED AT THE COMPLETION OF THE WORK. ALL REVISIONS/DRAWING CHANGES MUST NOT BE PRICED FOR CONSTRUCTION UNLESS LABELED ISSUED FOR TENDER/CONSTRUCTION.

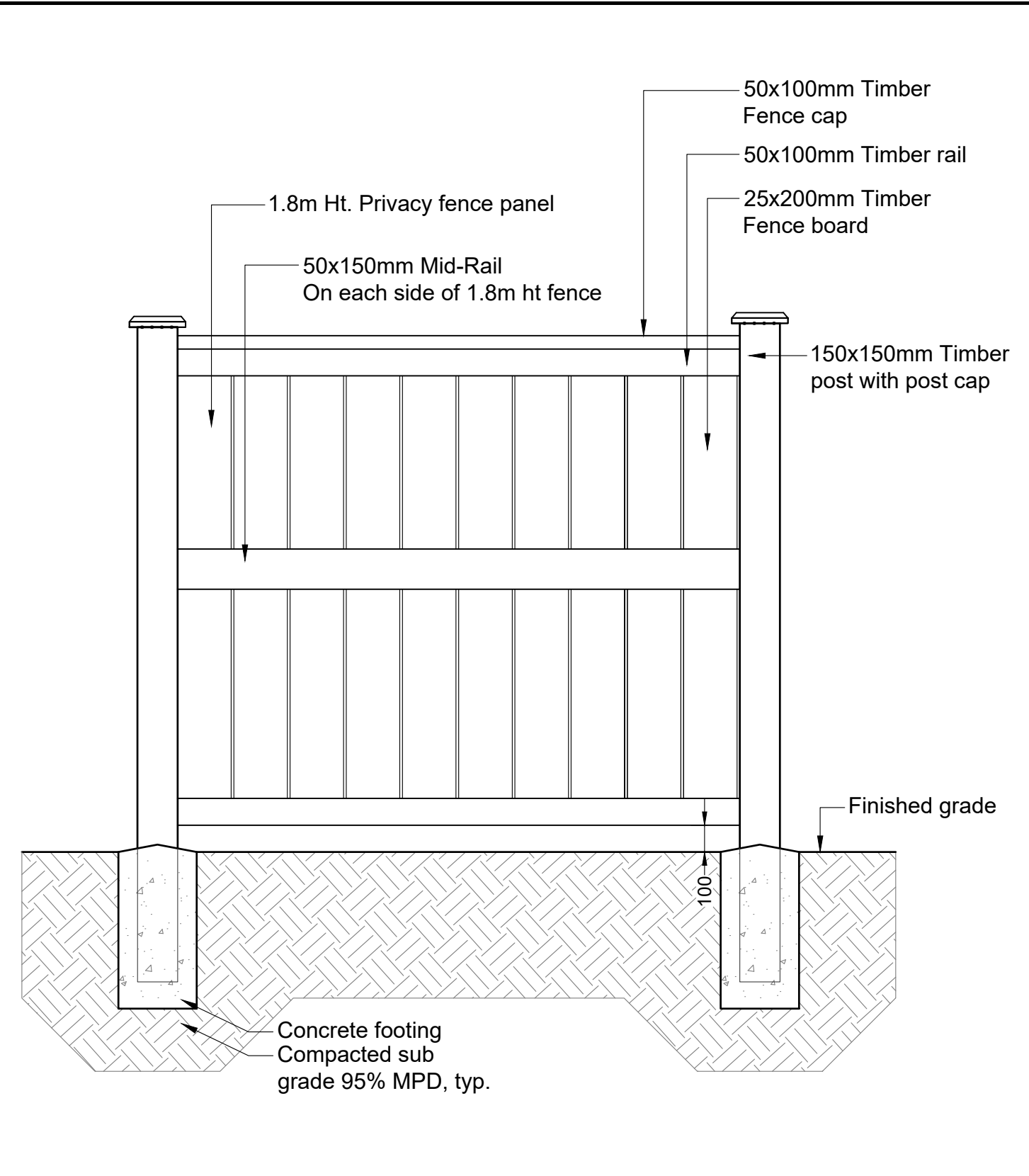

- Notes:**
1. All lumber to be Western Red Cedar - Standard and Better, S4S.
 2. All hardware and metal fixtures to be hot dipped galvanized and black powder coated.
 3. Lumber to be treated with linseed oil or stain to be approved by client.
 4. Contractor to provide shop drawings for approval by the Landscape Architect.

1 1.8m PRIVACY FENCE
Scale 1:20



2 ENTRY ARBOR
Scale NTS



3 BIKE RACK
Scale NTS



4 BENCH
Scale NTS

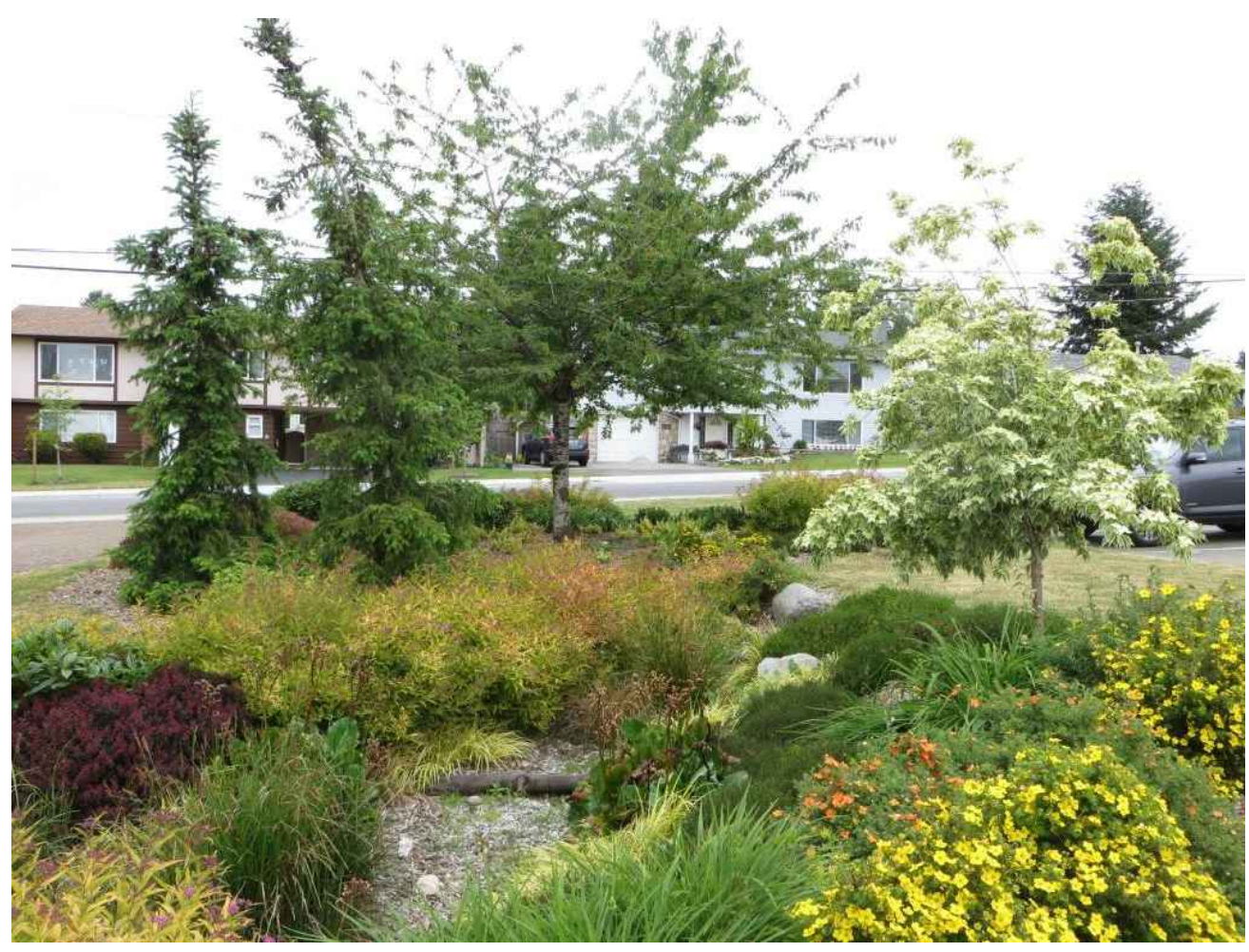

5 RAIN GARDEN
Scale NTS

Stamp:

#	By	Description	Date
TABLE OF REVISIONS			

Details

Scale:
AS SHOWN
Original Sheet Size:
24"x36" (ARCH D)

Project Name:
Horseshoe Bay Rowhouse
Development
Project Address:
6544 Royal Ave. & 6388 Douglas St.
West Vancouver, BC
Project Number:

Client / Owner: Drawn: LG
Checked: AL
Approved: AL

CONTRACTOR SHALL CHECK ALL DIMENSIONS ON THE WORK AND REPORT ANY DISCREPANCY TO THE CONSULTANT BEFORE PROCEEDING. ALL DRAWINGS AND SPECIFICATIONS ARE THE EXCLUSIVE PROPERTY OF THE OWNER AND MUST BE RETURNED AT THE COMPLETION OF THE WORK. ALL REVISIONS TO DRAWINGS MUST NOT BE PRICED FOR CONSTRUCTION UNLESS LABELED ISSUED FOR TENDER/CONSTRUCTION.