

**PROPOSED SUBDIVISION PLAN OF
LOT 19, BLOCK 'H', DISTRICT LOT 879, GROUP 1,
NEW WESTMINSTER DISTRICT, PLAN 8066**

PLAN EPP

BCGS 92G034



THE INTENDED PLOT SIZE OF THIS PLAN IS
432 mm IN WIDTH BY 560 mm IN HEIGHT (C SIZE)
WHEN PLOTTED AT A SCALE OF 1:500

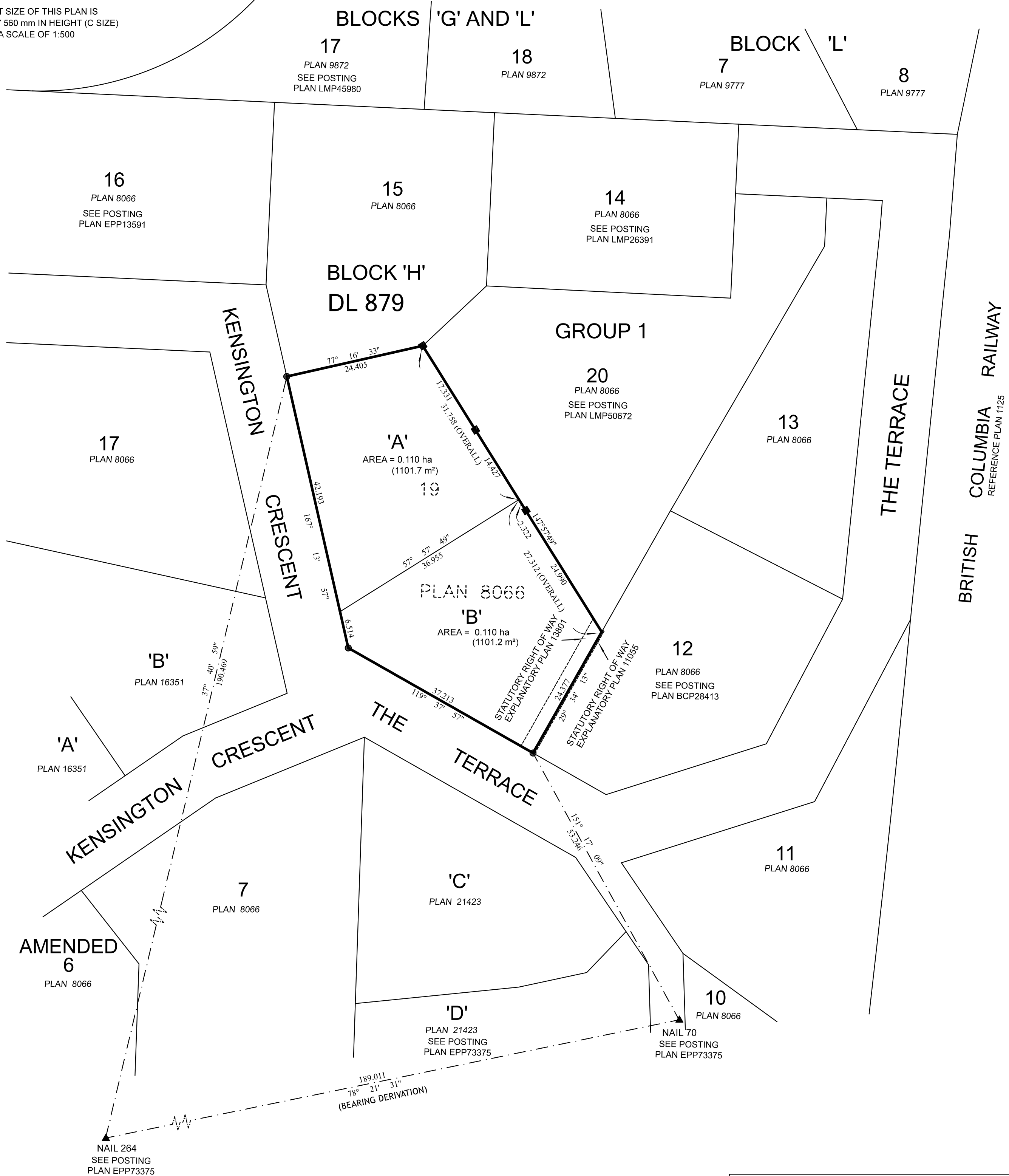

- LEGEND**
- ▲ DENOTES GNSS TRAVERSE POINT FOUND
 - DENOTES STANDARD IRON POST FOUND
 - DENOTES STANDARD IRON POST PLACED
 - DENOTES LEAD PLUG FOUND
 - DENOTES LEAD PLUG PLACED
 - NF DENOTES NOTHING FOUND
 - Wt DENOTES WITNESS

NOTE:
THIS PLAN SHOWS ONE OR MORE WITNESS POSTS
WHICH ARE NOT SET ON THE TRUE CORNER(S).

GRID BEARINGS ARE DERIVED FROM PLAN EPP73375 AND ARE REFERRED TO THE CENTRAL MERIDIAN OF UTM ZONE 10 (123° WEST LONGITUDE).
THIS PLAN SHOWS HORIZONTAL GROUND-LEVEL DISTANCES UNLESS OTHERWISE SPECIFIED. TO COMPUTE GRID DISTANCES, MULTIPLY GROUND-LEVEL DISTANCES BY THE AVERAGE COMBINED FACTOR OF 0.9995994. THE AVERAGE COMBINED FACTOR HAS BEEN DETERMINED BASED ON A MEAN ELLIPSOIDAL ELEVATION OF 110 METRES.

THE UTM COORDINATES AND ESTIMATED ABSOLUTE ACCURACY ACHIEVED ARE DERIVED FROM TIES TO TRAVERSE NAILS SET ON PLAN EPP73375

UTM COORDINATES			
DATUM: NAD83(CSRs) 4.0.0.BC.1.MVRD, UTM ZONE 10			
MARKER	NORTHING	EASTING	ABSOLUTE ACCURACY (ESTIMATED)
NAIL 70	5466157.28	480776.18	0.05 METRES
NAIL 264	5466119.16	480591.14	0.05 METRES

THE FIELD SURVEY REPRESENTED BY THIS PLAN WAS COMPLETED ON THE XXTH DAY OF APRIL, 2024
ALEXANDER ELLIOT HEATH, BCLS (921)

THIS PLAN LIES WITHIN THE
METRO VANCOUVER REGIONAL DISTRICT

P.I.D. 010-262-938
5365 KENSINGTON CRESCENT
FB.3008 p.11 - 23 M3478-15 WV

HOBBS, WINTER & MacDONALD,
B.C. LAND SURVEYORS,
113-828 HARBOURSIDE DRIVE,
NORTH VANCOUVER, B.C., V7P 3R9
TEL 604-986-1371 FAX 604-986-5204
EMAIL: admin@hwnmsurveys.com

