

'D'
PLAN 18128

2
PLAN 16084

TOPOGRAPHIC PLAN SHOWING
PROPOSED SUBDIVISION OF
LOT 2, BLOCK 'H',
DISTRICT LOT 582
GROUP 1, NEW WESTMINSTER DISTRICT
PLAN 6597
P.I.D. 010-849-939
SCALE: 8 FEET TO 1 INCH

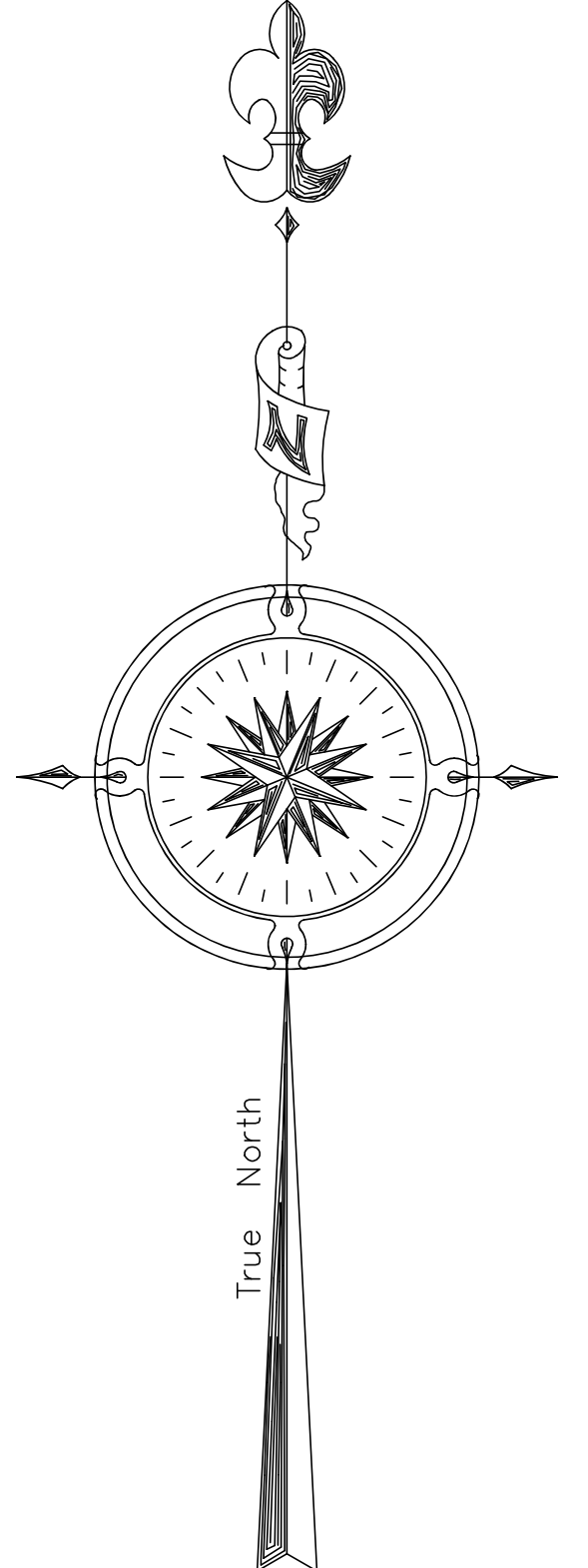
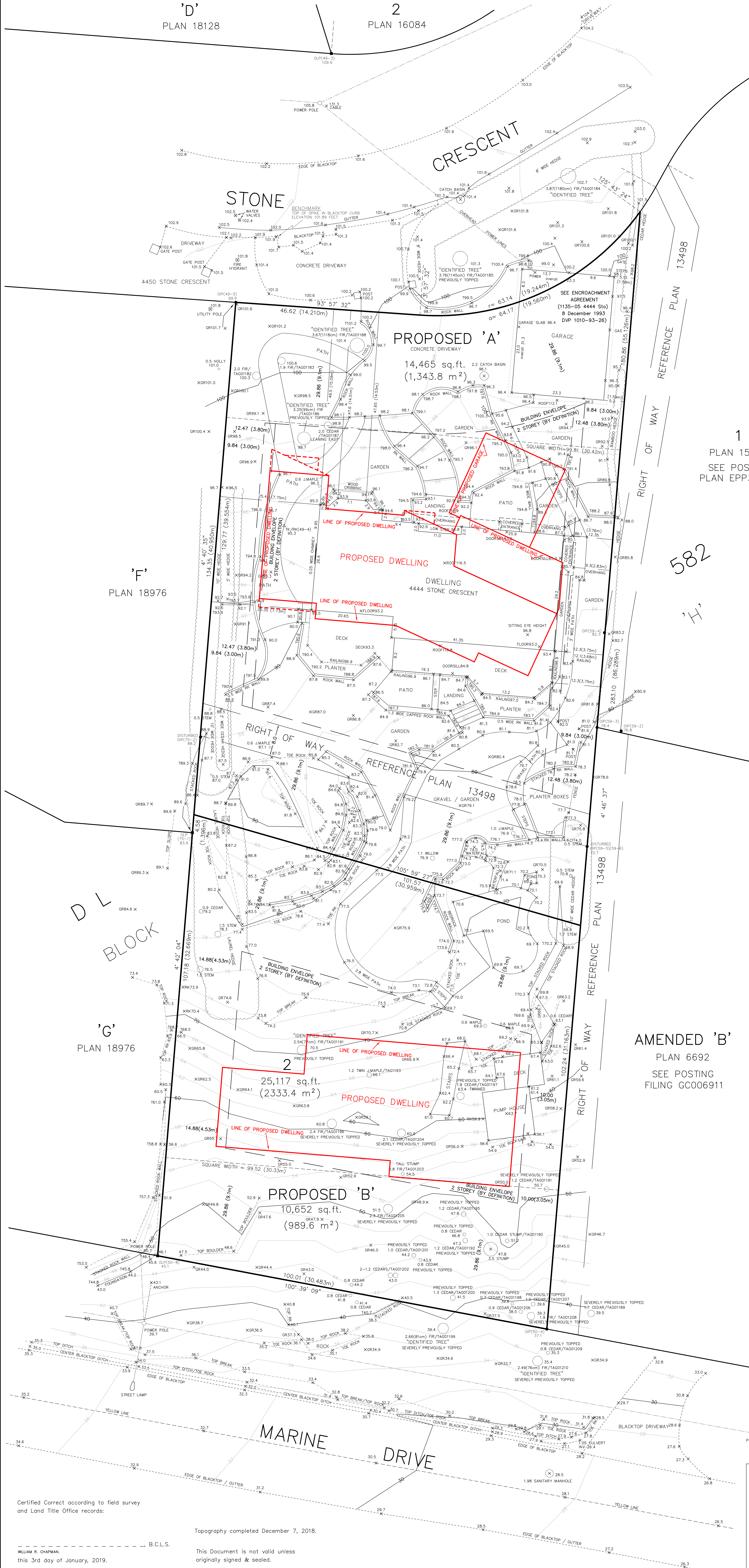

1
PLAN 15588
SEE POSTING
PLAN EPP35562

AMENDED 'B'
PLAN 6692
SEE POSTING
FILING GC006911

Note:
(10.00m) denotes metric equivalent.

Note:
Elevations are to Geodetic Datum
and are derived from Manhole 73
located at 4469 Marine Drive;
Invert elevation = 38.75 feet (11.81m).

Zoning RS3: PROPOSED 'A'
Square Width = 99.81 (30.42m).
Front Setback = 29.86 feet (9.1m).
Rear Setback = 29.86 feet (9.1m).
Combined Sideyard = 24.95 (7.61m).

Building envelope to be confirmed by
the West Vancouver Building Department.

Zoning RS3: PROPOSED 'B'
Square Width = 99.52 (30.33m).
Front Setback = 29.86 feet (9.1m).
Rear Setback = 29.86 feet (9.1m).
Combined Sideyard = 24.88 (7.58m).

Building envelope to be confirmed by
the West Vancouver Building Department.

© CHAPMAN LAND SURVEYING LTD. 2019
British Columbia Land Surveyors
107-100 Park Royal South
WEST VANCOUVER, B.C.
V7T 1A2 604-926-7311
FAX 604-926-6923
EMAIL: bill@choplansurvey.com

J5 B:2356(47) JOB:18-137 FILE:2727E COMP:2727E-2101

4444 STONE CRESCENT
FB.30.35 p. 31-39 M3505-14-B WV KS
REINSPECTED AND UPDATED TOPOGRAPHY
AND ADDED PROPOSED DWELLING
THIS 25TH DAY OF FEBRUARY, 2025
ADDED PROPOSED DWELLING OUTLINE ON PROPOSED LOT B
THIS 19TH DAY OF JUNE, 2025
THIS DOCUMENT IS NOT VALID UNLESS
ORIGINALLY SIGNED AND SEALED
© THIS PLAN IS THE COPYRIGHT PROPERTY
OF HOBBS, WINTER & MACDONALD
UNAUTHORIZED USE OR REPRODUCTION
IS STRICTLY PROHIBITED
HOBBS, WINTER & MACDONALD
B.C. LAND SURVEYORS
113-828 HARBOURSIDE DRIVE,
NORTH VANCOUVER, B.C. V7P 3R9
TEL 604-986-1371 FAX 604-986-5204
EMAIL: admin@hwmsurveys.com

Certified Correct according to field survey
and Land Title Office records:

Topography completed December 7, 2018.

WILLIAM R. CHAPMAN
this 3rd day of January, 2019.

This Document is not valid unless
originally signed & sealed.

DRM B.C.L.S.