

SITE PLAN

LEGEND

- ⊙ PERMANENT POWER POLE
(TOP OF THE POWER POLE IS @ 16' ABOVE GROUND)

No.	Description	Date
1	SUBMISSION	SEP. 29, 2025

**338 MOYNE DR
WEST VANCOUVER
BC**

**SITE PLAN & POWER
POLE LOCATION**

Project number	
Date	SEPT.29.2025
Drawn by	YUN HSI CHEN
Checked by	YUN HSI CHEN

A1a

Scale 1/8" = 1'-0"

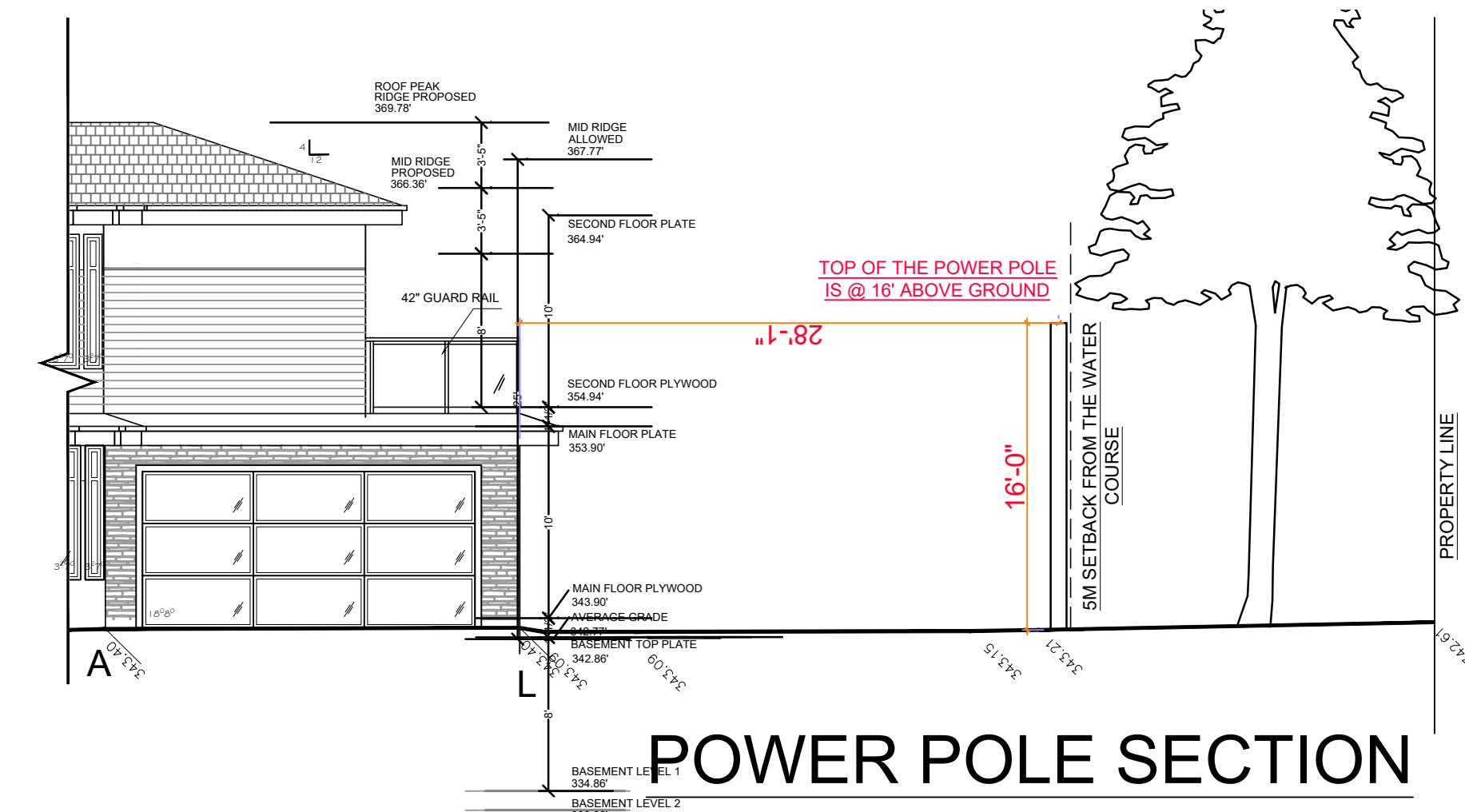

POWER POLE SECTION